

FX10-12-14

Submersible well pumps

The FX series submersible well pumps are semi-axial type, entirely produced in cast AISI 316 stainless steel.

The series comprises 4 impeller types for 10" pumps and 2 types each for 12" and 14" pumps. They are designed for easy management of disassembled pumps and spare parts, enabling direct customer assembly with practical kits.

The hexagonal shaft is fully covered by ceramic-coated steel bushings. Guide bushings are rubber for continuous operation under heavy loads, especially high sand content. Impeller wear rings are special rubber.

Couplings standardized per NEMA 6" and 8" norms (various options for larger motors). Discharge port threaded or flanged on request. Rotation: counterclockwise viewed from discharge. Continuous duty allowed.

Clean, non-aggressive water: deep well pumping (domestic/industrial), water lifting systems, flow/sprinkler irrigation, waterworks, pressurization, fire-fighting/washing systems, autoclave/tank feeding.

Construction features

Suction and delivery outlet	stainless steel AISI 316
Impellers	stainless steel AISI 316
Diffusers	stainless steel AISI 316
Support bush with sleeve	EPDM + ceramic-coated stainless steel AISI 316L
Shaft	stainless steel AISI 316
Coupling	stainless steel AISI 316
Quantity of sand in the water	2000 g/m ³
Max liquid temperature	max 75 °C
Non-return valve	standard on all models

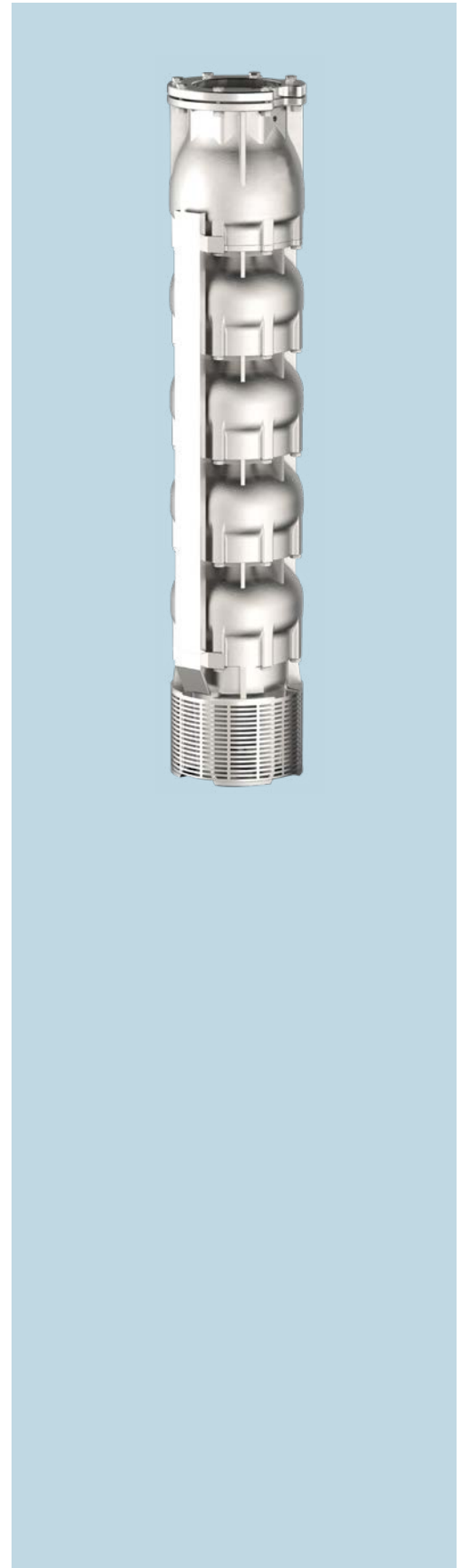

FX10 190

50 Hz - 2900 rpm					Q									
TYPE	WITH FME MOTOR			l/min	0	700	1800	2200	2600	3000	3400	3800	4000	
	P2		Ø	3- 400V	l/sec	0	11,7	30,0	36,7	43,3	50,0	56,7	63,3	66,7
	HP	kW		A	m ³ /h	0	42	108	132	156	180	204	228	240
FX10 190/01R10-025	25	18,5	6"	41	H (m)	38	38	35	33	31	28	24	20	18
FX10 190/01-030	30	22		47		42	41	38	36	34	31	28	23	21
FX10 190/02R10-050	50	37	8"	76		76	75	70	66	61	55	48	40	35
FX10 190/02-060	60	45		90		83	82	77	73	68	62	55	47	41
FX10 190/03R10-075	80	60		118		104	102	95	89	82	73	62	49	42
FX10 190/03-090	90	67		129		125	124	115	109	102	93	83	70	62
FX10 190/04R10-100	100	75		145		152	150	140	132	122	110	96	79	70
FX10 190/04-125	125	93		181		166	165	154	146	136	124	110	94	82
FX10 190/05R10-125	125	93		181		190	188	175	165	153	138	120	99	87
FX10 190/05-150	150	110		217		208	206	192	182	170	155	138	117	103
FX10 190/06R10-150	150	110	10"	217		228	225	210	198	184	166	144	119	104
FX10 190/06-180	180	132		257		250	247	230	218	204	186	166	140	124
FX10 190/07R10-180	180	132		257		266	263	245	231	214	193	168	139	122
FX10 190/07-200	200	150		300		291	288	269	255	238	217	193	164	144
FX10 190/08R10-200	200	150		300		304	300	280	264	245	221	192	158	139
FX10 190/08-230	230	170		340		333	330	307	291	272	248	221	187	165
FX10 190/09-260	260	190		380		374	371	346	328	306	279	248	211	185
FX10 190/10-300	300	220		12"		424	416	412	384	364	340	310	276	234
FX10 190/11-340	340	250	481			458	453	422	400	374	341	304	257	227

Eff. max % R10 =	77,5
Eff. max %	77
Max kW / St. R10 =	18,5
Max kW / St.	20,8

NPSH (m)	Q=25%	Q=50%	Q=75%	Q=100%
	3,4	5	7,8	11,8



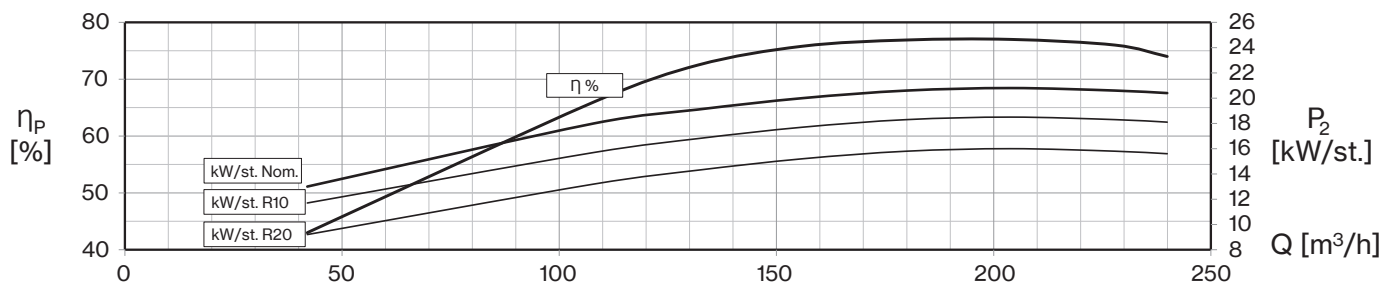
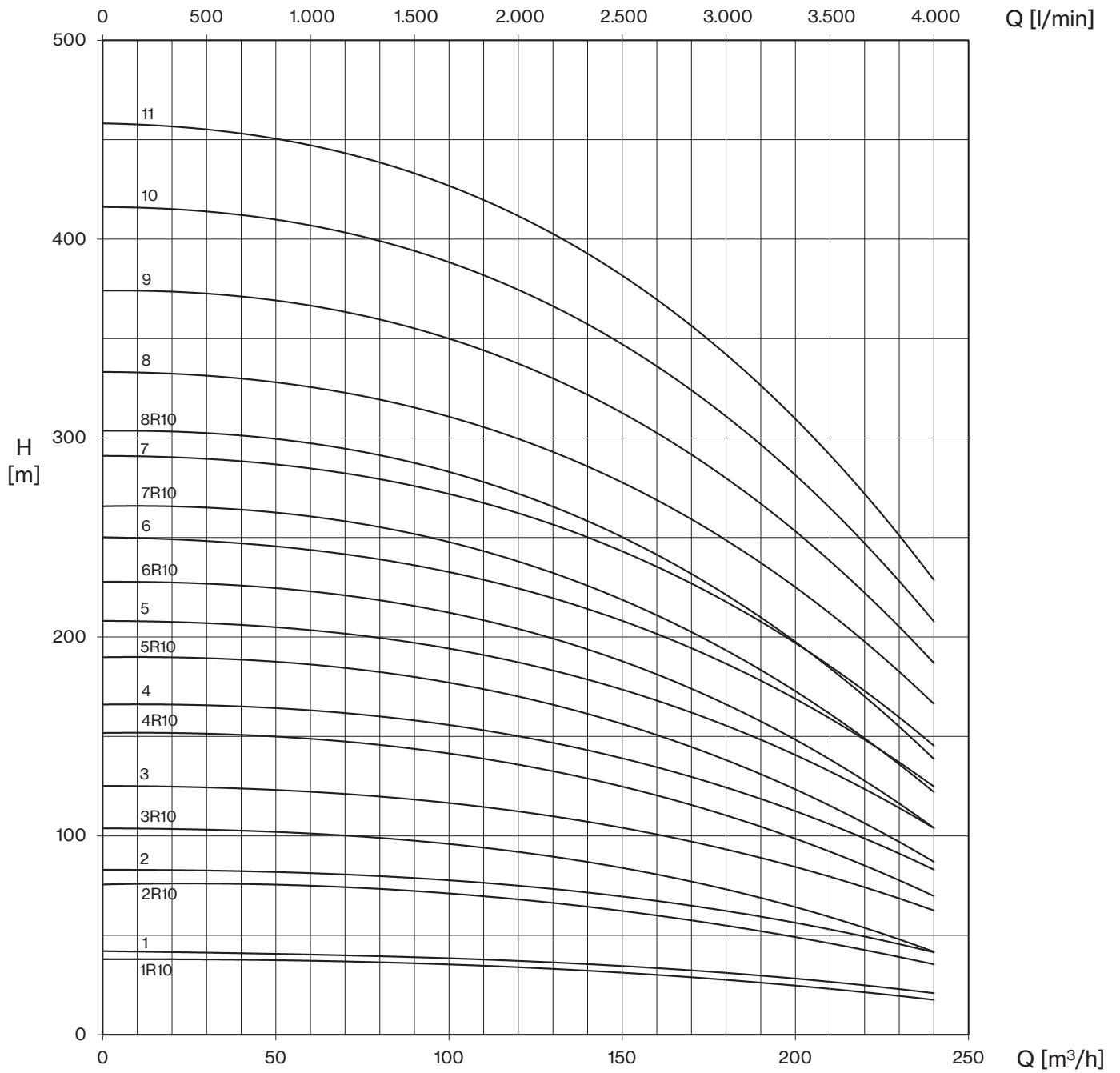

FX10 230

50 Hz - 2900 rpm					Q										
TYPE	WITH FME MOTOR			l/min	0	800	2200	2600	3000	3400	3800	4200	4600		
	P2		Ø	3- 400V	l/sec	0	13,3	36,7	43,3	50,0	56,7	63,3	70,0	76,7	
	HP	kW		A	m³/h	0	48	132	156	180	204	228	252	276	
FX10 230/01R20-025	25	18,5	6"	41	H (m)	37	36	31	29	27	25	23	19	16	
FX10 230/01-035	35	26		58		44	43	38	36	34	32	30	26	23	
FX10 230/02R20-050	50	37	8"	76		74	71	62	58	54	50	45	38	32	
FX10 230/02-080	80	60		118		88	85	75	72	68	64	59	53	46	
FX10 230/03R20-080	80	60		118		110	107	93	87	81	75	68	57	48	
FX10 230/03R10-090	90	67		129		121	116	102	98	92	86	78	68	59	
FX10 230/03-100	100	75		145		131	128	113	108	102	96	89	79	69	
FX10 230/04-125	125	93		181		175	170	150	144	136	128	118	106	92	
FX10 230/05R10-150	150	110	10"	217		202	193	170	163	153	143	130	114	98	
FX10 230/05-180	180	132		257		219	213	188	180	170	160	148	132	115	
FX10 230/06R10-180	180	132		257		242	231	204	195	183	171	156	137	117	
FX10 230/06-200	200	150		300		263	255	225	216	204	192	178	159	138	
FX10 230/07R10-200	200	150		300		283	270	238	228	214	200	182	160	137	
FX10 230/07-230	230	170		340		307	298	263	252	238	224	207	185	161	
FX10 230/08R10-230	230	170		340		323	308	272	261	245	229	208	182	157	
FX10 230/08-260	260	190		380		350	340	301	288	272	256	237	211	184	
FX10 230/09-300	300	220		12"		424	394	383	338	324	306	288	266	238	207
FX10 230/10-340	340	250				481	438	425	376	360	340	320	296	264	230
FX10 230/11-340	340	250	481			482	468	413	396	374	352	326	291	253	

Eff. max % R20 =	78,4
Eff. max % R10 =	79,5
Eff. max %	79,2
Max kW / St. R20 =	17,5
Max kW / St. R10 =	19,5
Max kW / St.	22,8

NPSH (m)	Q=25%	Q=50%	Q=75%	Q=100%
	3,4	5	7,8	11,8



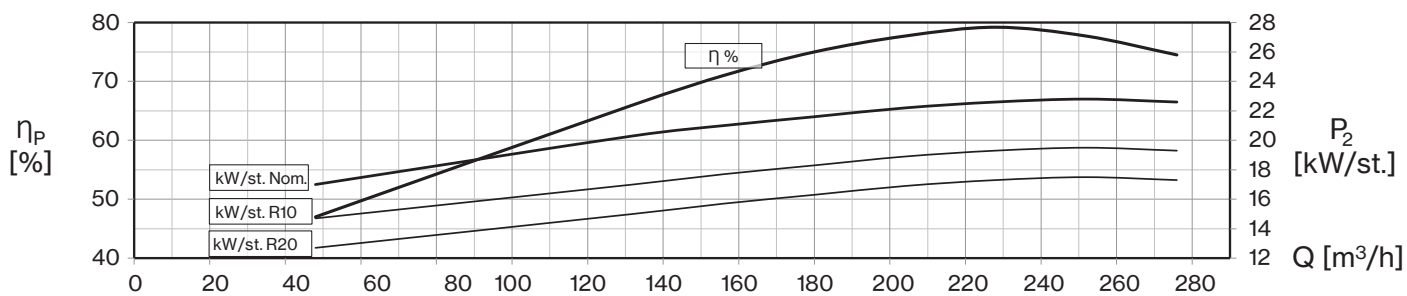
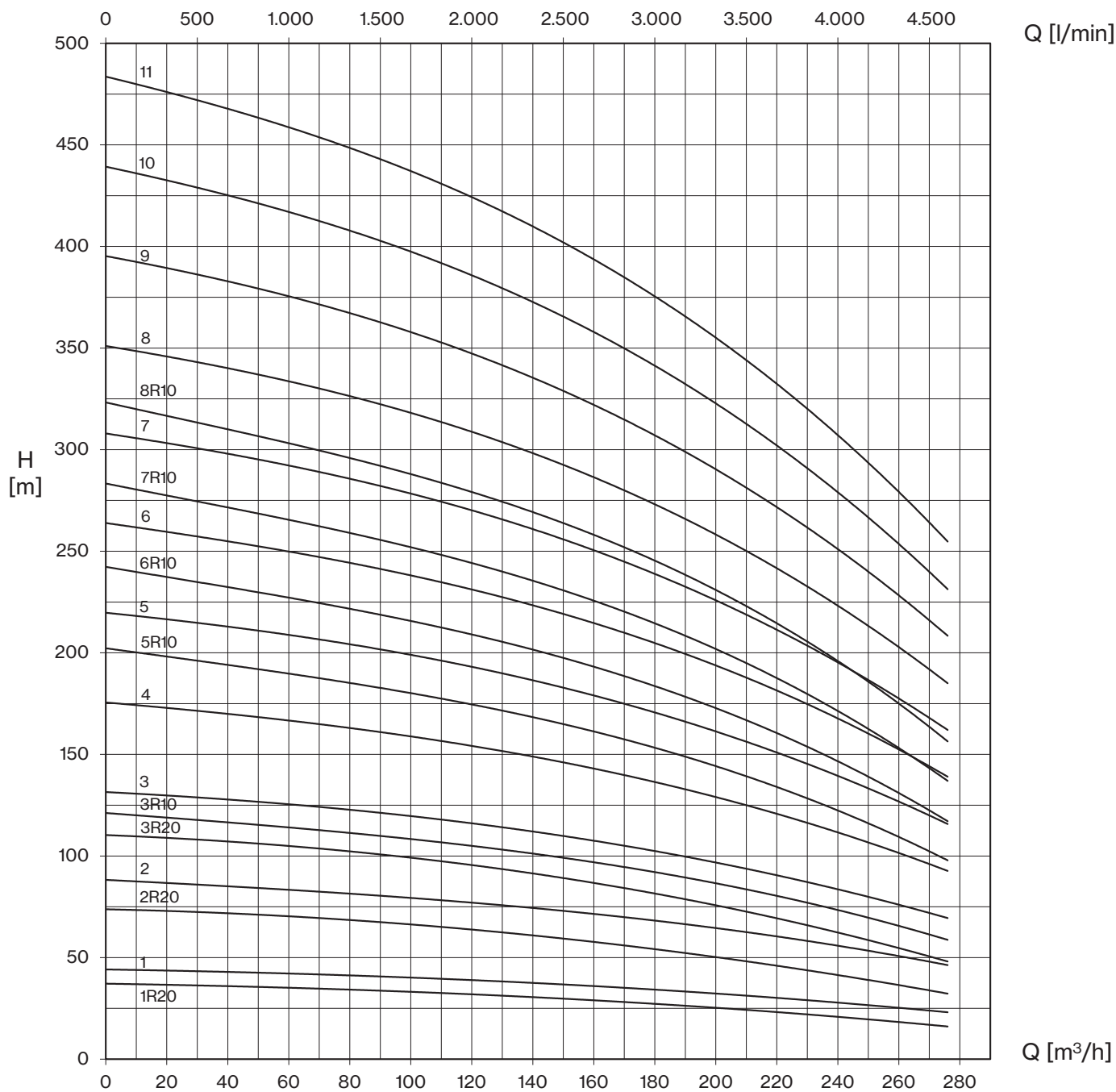

FX10 250

50 Hz - 2900 rpm					Q									
TYPE	WITH FME MOTOR			l/min	0	1000	3200	3600	4000	4400	4800	5000	5200	
	P2		Ø	3- 400V	l/sec	0	16,7	53,3	60,0	66,7	73,3	80,0	83,3	86,7
	HP	kW		A	m³/h	0	60	192	216	240	264	288	300	312
FX10 250/01R20-025	25	18,5	6"	41	H (m)	31	31	27	25	23	21	18	17	14
FX10 250/01-040	40	30		61		44	42	34	32	30	28	26	25	24
FX10 250/02R20-050	50	37		76		63	62	54	50	46	42	36	33	27
FX10 250/02-080	80	60	118	88		84	67	64	59	56	52	50	48	
FX10 250/03R20-080	80	60	8"	118		94	93	81	75	69	63	54	50	41
FX10 250/03R10-100	100	75		145		107	107	93	86	80	73	65	59	53
FX10 250/03-125	125	93		181		132	126	101	96	89	83	78	75	72
FX10 250/04R10-125	125	93	10"	181		143	142	124	115	107	97	87	79	70
FX10 250/04-150	150	110		217		176	168	134	128	118	111	104	100	96
FX10 250/05R10-180	180	132		257		179	178	155	144	134	121	109	99	88
FX10 250/05-200	200	150	10"	300		220	210	168	160	148	139	130	125	120
FX10 250/06R10-200	200	150		300		214	214	186	172	160	146	130	118	106
FX10 250/06-230	230	170		340		264	252	202	192	178	167	156	150	144
FX10 250/07R10-230	230	170	12"	340		251	249	217	202	188	169	153	139	123
FX10 250/07-300	300	220		424		308	294	235	224	207	195	182	175	168
FX10 250/08-300	300	220		424		352	336	269	256	237	222	208	200	192
FX10 250/09-340	340	250	12"	481		396	378	302	288	266	250	234	225	216
FX10 250/10-400	400	300		575		440	420	336	320	296	278	260	250	240
FX10 250/11-400	400	300		575	484	462	370	352	326	306	286	275	264	

Eff. max % R20 =	79
Eff. max % R10 =	79,5
Eff. max %	79,3
Max kW / St. R20 =	18
Max kW / St. R10 =	22,5
Max kW / St.	27,4

NPSH (m)	Q=25%	Q=50%	Q=75%	Q=100%
	3,4	5	7,8	11,8



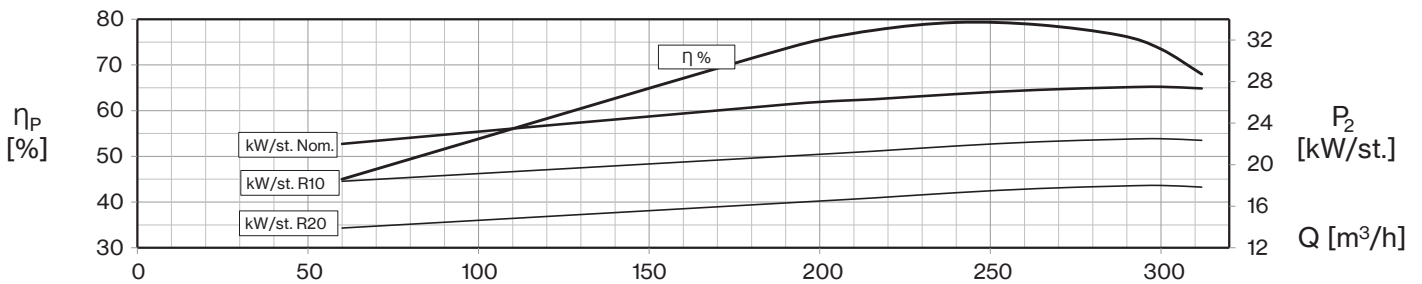
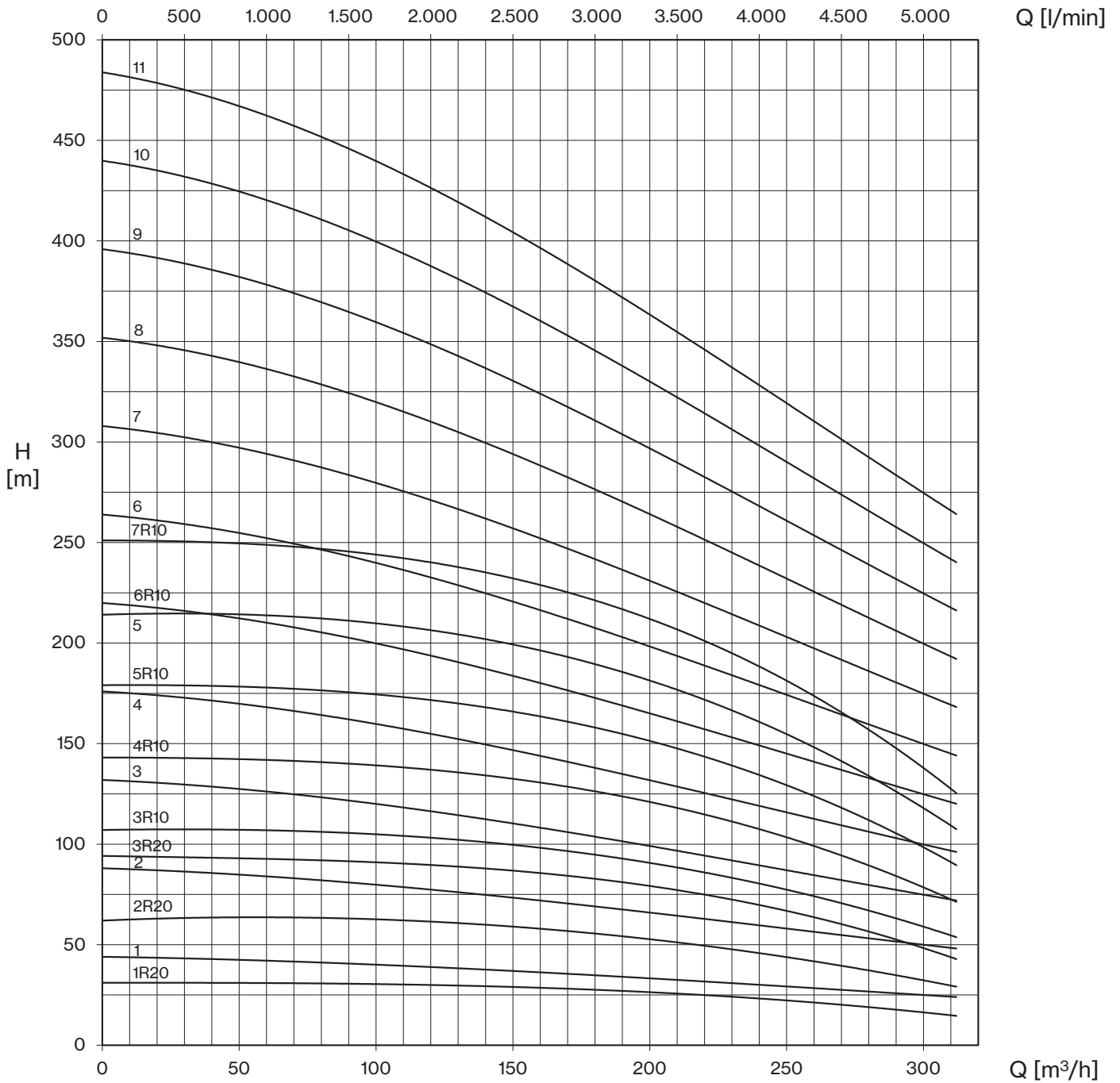

FX10 275

50 Hz - 2900 rpm					Q									
TYPE	WITH FME MOTOR			l/min	0	1000	3400	3800	4200	4600	5000	5400	5800	
	P2		Ø	3- 400V	l/sec	0	16,7	56,7	63,3	70,0	76,7	83,3	90,0	96,7
	HP	kW		A	m³/h	0	60	204	228	252	276	300	324	348
FX10 275/01R20-035	35	26	6"	58	H (m)	36	36	28	26	25	23	21	19	16
FX10 275/01-050	50	37		76		45	44	37	35	34	32	30	28	25
FX10 275/02R20-070	70	52	8"	102		72	71	56	52	50	46	42	39	32
FX10 275/02-090	90	67		129		90	87	73	70	67	63	60	56	50
FX10 275/03R10-125	125	93		181		122	121	97	92	88	82	77	72	62
FX10 275/03-150	150	110	10"	217		135	131	110	105	101	95	90	85	75
FX10 275/04-180	180	132		257		180	175	146	140	134	126	120	113	100
FX10 275/05R10-200	200	150		300		204	202	162	154	147	137	129	120	104
FX10 275/05-230	230	170		340		225	219	183	175	168	158	150	141	125
FX10 275/06R10-260	260	190	12"	380		245	242	194	185	176	164	155	144	125
FX10 275/06-300	300	220		424		270	262	220	210	202	190	180	169	150
FX10 275/07R10-300	300	220	12"	424		286	282	227	216	206	192	181	168	146
FX10 275/07-340	340	250		481		315	306	256	245	235	221	210	197	175
FX10 275/08-400	400	300		575		360	350	293	280	269	253	240	226	200
FX10 275/09-400	400	300	14"	575		405	393	329	315	302	284	270	254	225
FX10 275/10-450	450	330		620		450	437	366	350	336	316	300	282	250
FX10 275/11-500	500	370		690		495	481	403	385	370	348	330	310	275

Eff. max % R20 =	76,1
Eff. max % R10 =	77,2
Eff. max %	76,5
Max kW / St. R20 =	25
Max kW / St. R10 =	29
Max kW / St.	33

NPSH (m)	Q=25%	Q=50%	Q=75%	Q=100%
	3,4	5	7,8	11,8



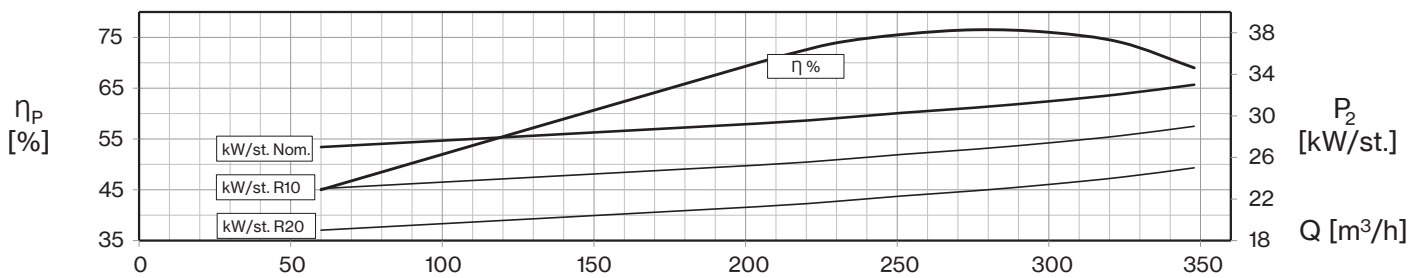
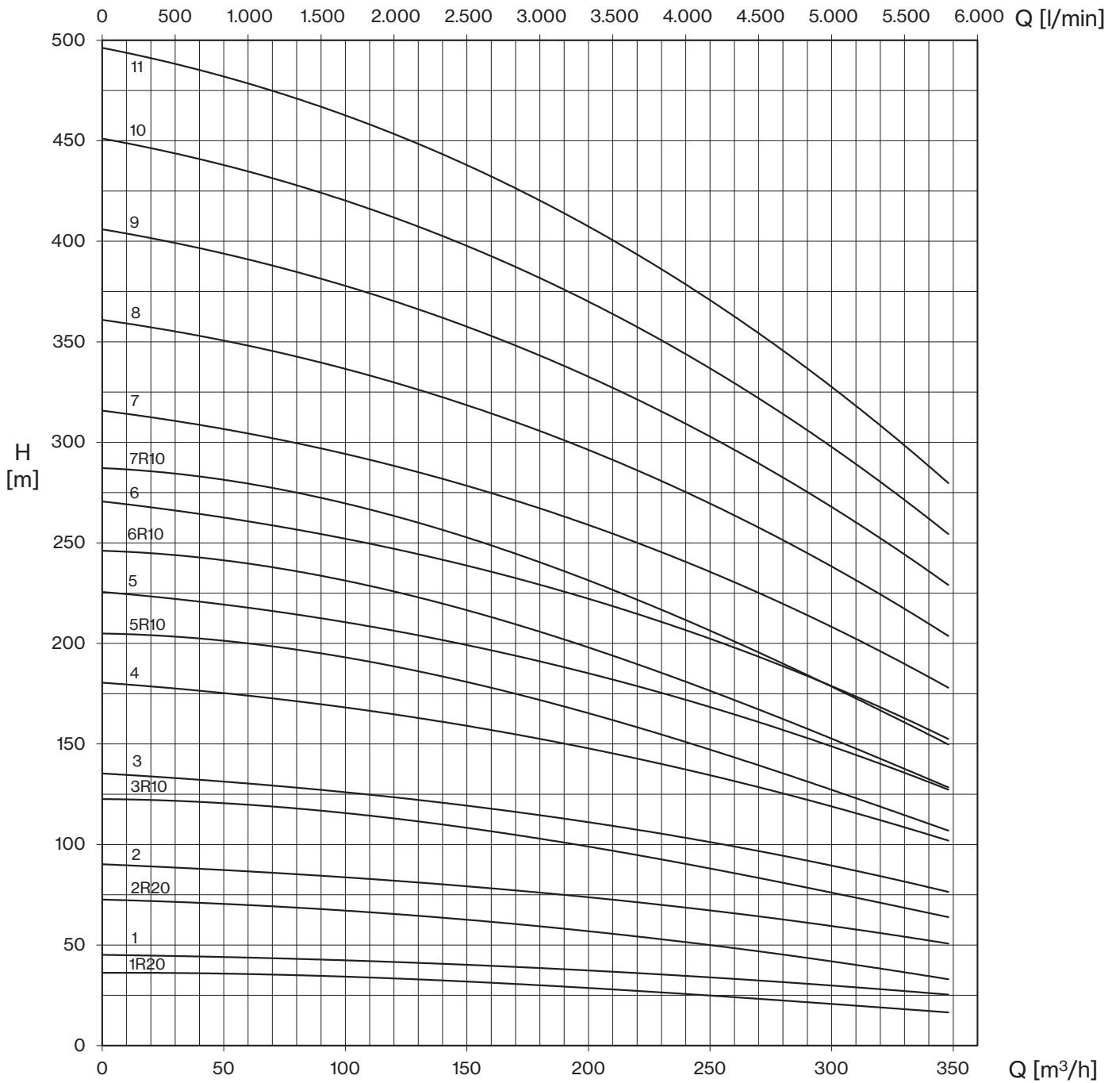

FX10

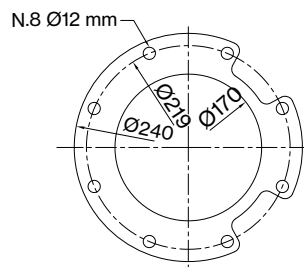
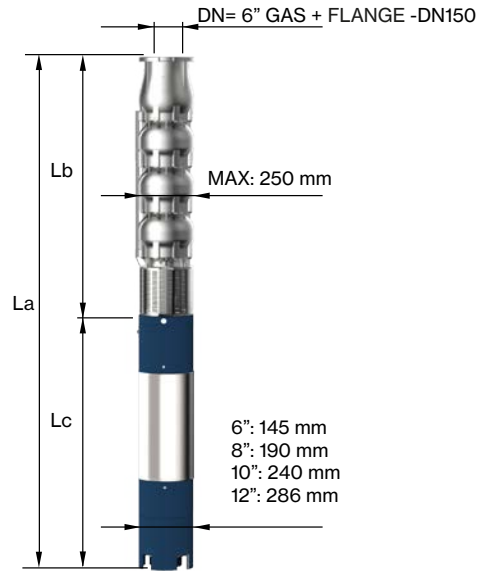

FOR COMMERCIAL TUBE
EXTERNAL DIAMETER: 168,3 mm

"R": Reduced diameter impellers

TYPE	MOTOR BRACKET	ST	DIMENSIONS (mm)			WEIGHT (kg)		
			La	Lb	Lc	La	Lb	Lc
3~								
FX10 190/01R10-025	6" NEMA	1	1635	625	1010	121	41	80
FX10 190/01-030		1	1735	625	1110	131	41	90
FX10 190/02R10-050	8" NEMA	2	2005	805	1200	194	56	138
FX10 190/02-060		2	2105	805	1300	201	56	145
FX10 190/03R10-075		3	2415	985	1430	255	72	183
FX10 190/03-090		3	2445	985	1460	265	72	193
FX10 190/04R10-100		4	2645	1165	1480	287	87	200
FX10 190/04-125		4	2945	1165	1780	338	87	251
FX10 190/05R10-125	10"	5	2945	1165	1780	338	87	251
FX10 190/05-150		5	3085	1165	1920	472	87	385
FX10 190/06R10-150		6	3085	1165	1920	472	87	385
FX10 190/06-180		6	3185	1165	2020	522	87	435
FX10 190/07R10-180		7	3725	1705	2020	569	134	435
FX10 190/07-200		7	3845	1705	2140	634	134	500
FX10 190/08R10-200		8	4025	1885	2140	649	149	500
FX10 190/08-230		8	4125	1885	2240	689	149	540
FX10 190/09-260	12"	9	4405	2065	2340	745	165	580
FX10 190/10-300		10	4355	2245	2110	880	180	700
FX10 190/11-340		11	4705	2425	2280	971	196	775



TYPE 3~	MOTOR BRACKET	ST	DIMENSIONS (mm)			WEIGHT (kg)		
			La	Lb	Lc	La	Lb	Lc
FX10 230/01R20-025	6" NEMA	1	1635	625	1010	121	41	80
FX10 230/01-035		1	1875	625	1250	147	41	106
FX10 230/02R20-050	8" NEMA	2	2005	805	1200	194	56	138
FX10 230/02-080		2	2235	805	1430	239	56	183
FX10 230/03R20-080		3	2415	985	1430	255	72	183
FX10 230/03R10-090		3	2445	985	1460	265	72	193
FX10 230/03-100		3	2465	985	1480	272	72	200
FX10 230/04-125		4	2945	1165	1780	338	87	251
FX10 230/05R10-150	10"	5	3265	1345	1920	488	103	385
FX10 230/05-180		5	3365	1345	2020	538	103	435
FX10 230/06R10-180		6	3545	1525	2020	553	118	435
FX10 230/06-200		6	3665	1525	2140	618	118	500
FX10 230/07R10-200		7	3845	1705	2140	634	134	500
FX10 230/07-230		7	3945	1705	2240	674	134	540
FX10 230/08R10-230		8	4125	1885	2240	689	149	540
FX10 230/08-260		8	4225	1885	2340	729	149	580
FX10 230/09-300	12"	9	4175	2065	2110	865	165	700
FX10 230/10-240		10	4525	2245	2280	955	180	775
FX10 230/11-340		11	4705	2425	2280	971	196	775

TYPE 3~	MOTOR BRACKET	ST	DIMENSIONS (mm)			WEIGHT (kg)		
			La	Lb	Lc	La	Lb	Lc
FX10 250/01R20-025	6" NEMA	1	1635	625	1010	121	41	80
FX10 250/01-040		1	1775	625	1150	179	41	138
FX10 250/02R20-050	8" NEMA	2	2005	805	1200	195	57	138
FX10 250/02-080		2	2235	805	1430	240	57	183
FX10 250/03R20-080		3	2415	985	1430	255	72	183
FX10 250/03R10-100		3	2465	985	1480	272	72	200
FX10 250/03-125		3	2765	985	1780	323	72	251
FX10 250/04R10-125		4	2945	1165	1780	339	88	251
FX10 250/04-150	10"	4	3085	1165	1920	473	88	385
FX10 250/05R10-180		5	3365	1345	2020	538	103	435
FX10 250/05-200		5	3485	1345	2140	603	103	500
FX10 250/06R10-200		6	3665	1525	2140	619	119	500
FX10 250/06-230		6	3765	1525	2240	659	119	540
FX10 250/07R10-230		7	3945	1705	2240	674	134	540
FX10 250/07-300	12"	7	3815	1705	2110	834	134	700
FX10 250/08-300		8	3995	1885	2110	850	150	700
FX10 250/09-340		9	4345	2065	2280	940	165	775
FX10 250/10-400		10	4525	2245	2280	956	181	775
FX10 250/11-400		11	4705	2425	2280	971	196	775



FX10

TYPE 3~	MOTOR BRACKET	ST	DIMENSIONS (mm)			WEIGHT (kg)		
			La	Lb	Lc	La	Lb	Lc
FX10 275/01R20-035	6" NEMA	1	1875	625	1250	147	41	106
FX10 275/01-050	8" NEMA	1	1825	625	1200	179	41	138
FX10 275/02R20-070		2	2185	805	1380	224	57	167
FX10 275/02-090		2	2265	805	1460	250	57	193
FX10 275/03R10-125		3	2765	985	1780	323	72	251
FX10 275/03-150	10"	3	2905	985	1920	457	72	385
FX10 275/04-180		4	3185	1165	2020	523	88	435
FX10 275/05R10-200		5	3485	1345	2140	603	103	500
FX10 275/05-230		5	3585	1345	2240	643	103	540
FX10 275/06R10-260	12"	6	3865	1525	2340	699	119	580
FX10 275/06-300		6	3635	1525	2110	819	119	700
FX10 275/07R10-300		7	3815	1705	2110	834	134	700
FX10 275/07-340		7	3985	1705	2280	909	134	775
FX10 275/08-400	14"	8	4165	1885	2280	925	150	775
FX10 275/09-400		9	4345	2065	2280	940	165	775
FX10 275/10-450	14"	10	4405	2245	2160	1091	181	910
FX10 275/11-500		11	4745	2425	2320	1206	196	1010



FX12 360

50 Hz - 2900 rpm					Q									
TYPE	WITH FME MOTOR			l/min	0	1500	4000	4500	5000	5500	6000	6500	7000	
	P2		Ø	3- 400V	l/sec	0	25,0	66,7	75,0	83,3	91,7	100,0	108,3	116,7
	HP	kW		A	m ³ /h	0	90	240	270	300	330	360	390	420
FX12 360/01R35-050	50	37	8"	76	H (m)	41	40	37	35	33	32	29	-	-
FX12 360/01R20-080	80	60		118		49	48	47	45	44	42	40	38	34
FX12 360/01-090	90	67		129		62	61	55	53	52	52	50	47	42
FX12 360/02R35-100	100	75		145		82	80	73	70	66	63	57	-	-
FX12 360/02R20-150	150	110	10"	217		98	96	93	90	87	84	80	75	68
FX12 360/02-180	180	132		257		124	122	109	106	104	103	100	93	84
FX12 360/03R20-200	200	150	12"	300		147	144	140	135	131	126	120	113	102
FX12 360/03R10-260	260	190		371		165	162	152	149	144	140	132	126	120
FX12 360/03-300	300	220		424		186	183	164	159	156	155	150	140	126
FX12 360/04R20-300	300	220		424		196	192	186	180	174	168	160	150	136
FX12 360/04R10-340	340	250	14"	481		220	216	202	198	192	186	176	168	160
FX12 360/04-400	400	300		575		248	244	218	212	208	206	200	186	168
FX12 360/05R20-340	340	250	12"	481		245	240	233	225	218	210	200	188	170
FX12 360/05R10-400	400	300		575		275	270	253	248	240	233	220	210	200
FX12 360/05-450	450	330	14"	620		310	305	273	265	260	258	250	233	210
FX12 360/06R10-500	500	370		690		330	324	304	298	288	280	264	252	240
FX12 360/06-550	550	400		800	372	366	328	318	312	310	300	280	252	

Eff. max % R30 =	77,5
Eff. max % R20 =	80
Eff. max % R10 =	80,5
Eff. max %	81
Max kW / St. R35 =	36,8
Max kW / St. R20 =	49,5
Max kW / St. R10 =	55,2
Max kW / St.	64,2

NPSH (m)	Q=25%	Q=50%	Q=75%	Q=100%
	3,4	5	7,8	11,8



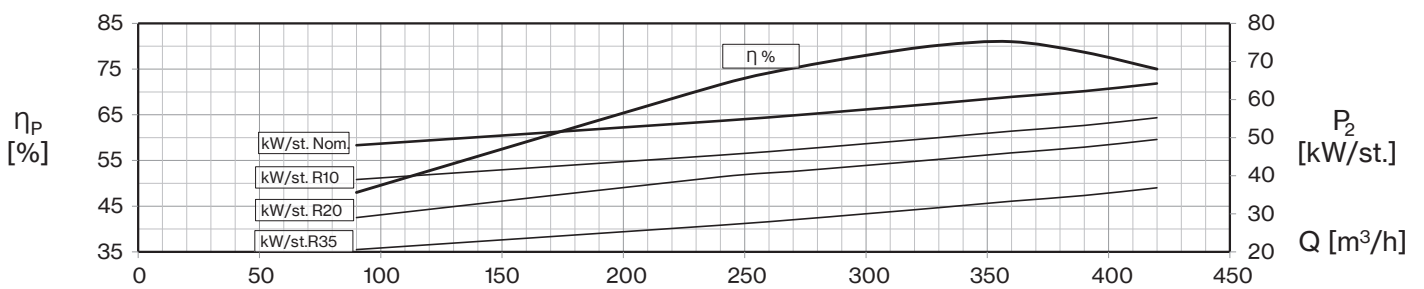
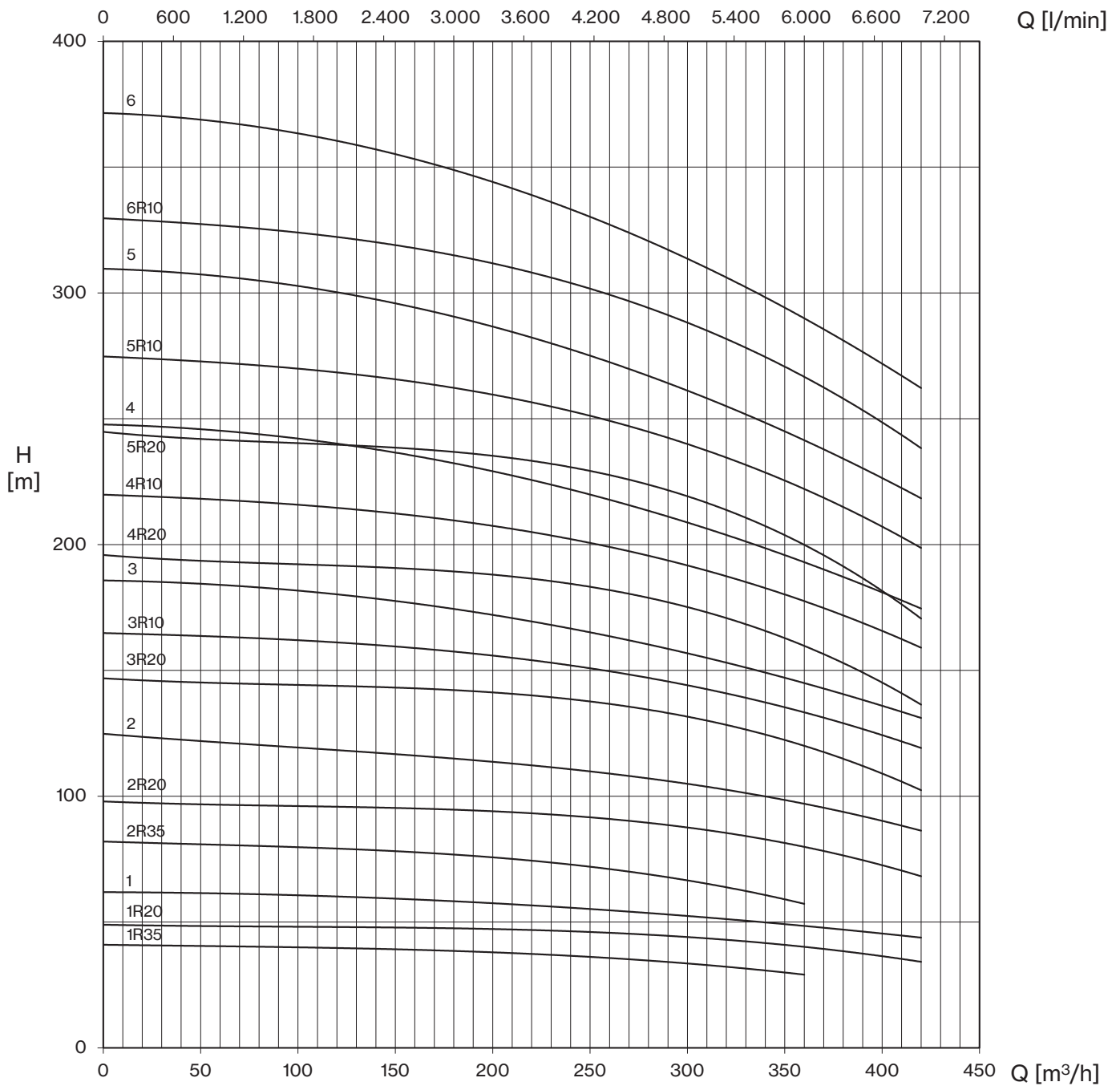

FX12 400

50 Hz - 2900 rpm					Q										
TYPE	WITH FME MOTOR			l/min	0	2000	6000	6500	7000	7500	8000	8500	9000		
	P2		Ø	3- 400V	l/sec	0	33,3	100,0	108,3	116,7	125,0	133,3	141,7	150,0	
	HP	kW		A	m ³ /h	0	120	360	390	420	450	480	510	540	
FX12 400/01R30-050	50	37	8"	76	H (m)	43	42	32	30	27	24	-	-	-	
FX12 400/01R20-080	80	60		118		47	45	37	35	33	30	26	22	-	-
FX12 400/01R10-080	80	60		118		53	52	42	40	38	36	32	28	-	-
FX12 400/01-090	90	67		129		58	57	46	44	42	40	37	31	27	-
FX12 400/02R30-100	100	75		145		86	84	64	59	54	48	-	-	-	-
FX12 400/02R20-125	125	93		181		94	90	73	69	65	59	52	44	-	-
FX12 400/02R10-150	150	110	10"	217		106	104	84	80	76	71	64	56	-	
FX12 400/02-180	180	132		257		116	114	92	88	84	80	73	62	54	
FX12 400/03R20-200	200	150		300		141	135	110	104	98	89	78	66	-	
FX12 400/03R10-230	230	170	12"	340		159	156	126	120	114	107	96	84	-	
FX12 400/03-260	260	190		371		174	171	138	132	126	120	110	93	81	
FX12 400/04R20-260	260	190	14"	371		188	180	146	138	130	118	104	88	-	
FX12 400/04R10-300	300	220		424		212	208	168	160	152	142	128	112	-	
FX12 400/04-340	340	250		481		232	228	184	176	168	160	146	124	108	
FX12 400/05R10-400	400	300	14"	575		265	260	210	200	190	178	160	140	-	
FX12 400/05-450	450	330		620		290	285	230	220	210	200	183	155	135	
FX12 400/06-500	500	370		690		348	342	276	264	252	240	220	186	162	

Eff. max % R30 =	81,2
Eff. max % R20 =	81,8
Eff. max % R10 =	82,7
Eff. max %	81,6
Max kW / St. R35 =	37
Max kW / St. R20 =	45,6
Max kW / St. R10 =	53
Max kW / St.	60,4

NPSH (m)	Q=25%	Q=50%	Q=75%	Q=100%
	3,4	5	7,8	11,8



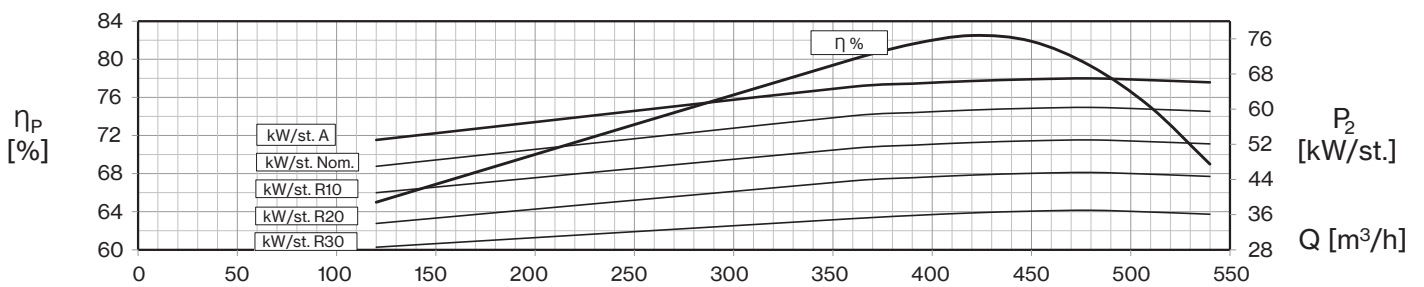
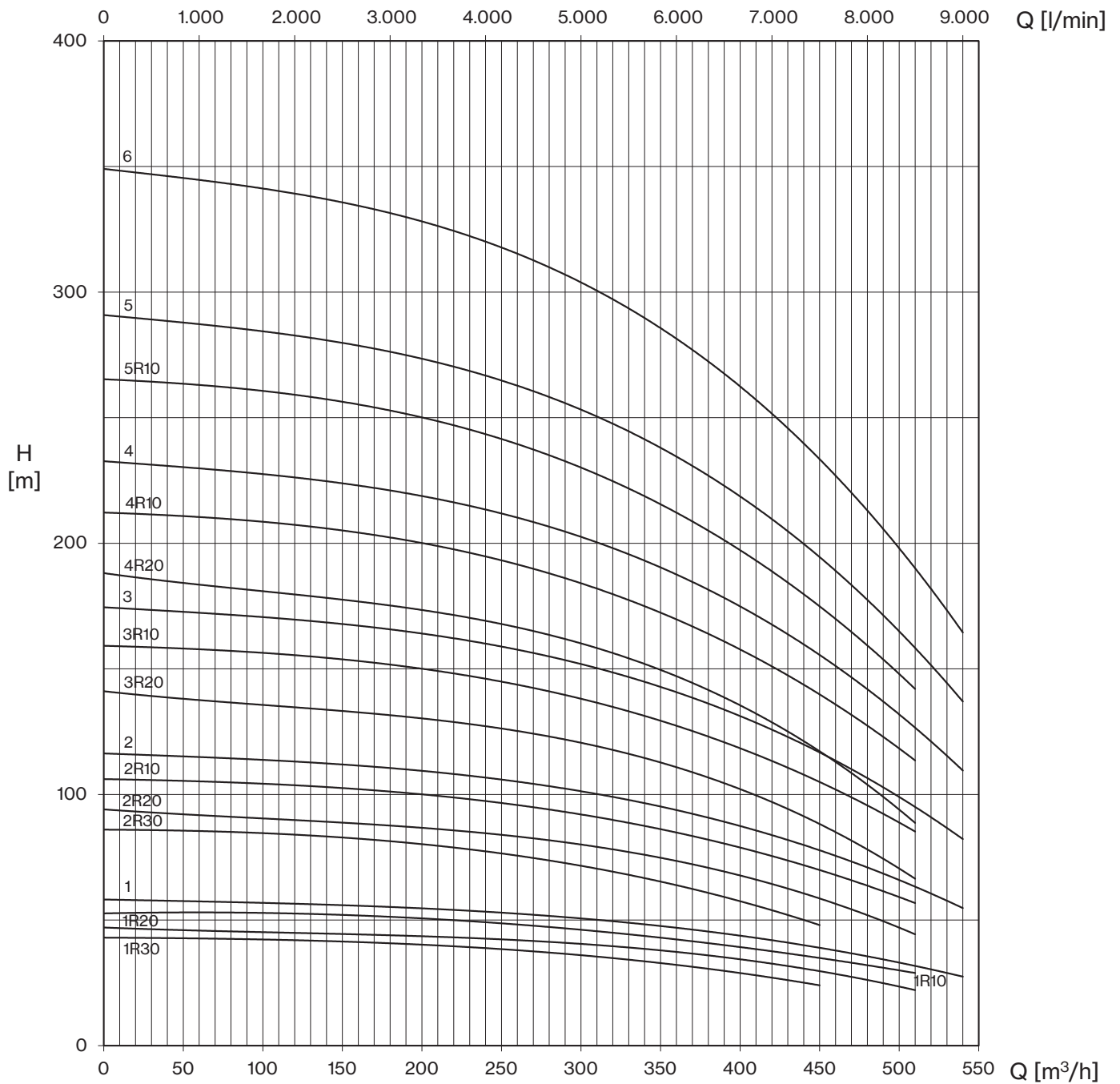

FX12

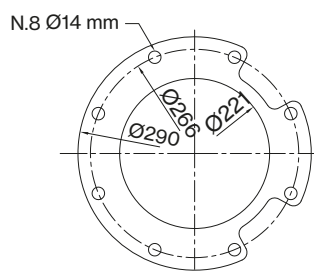
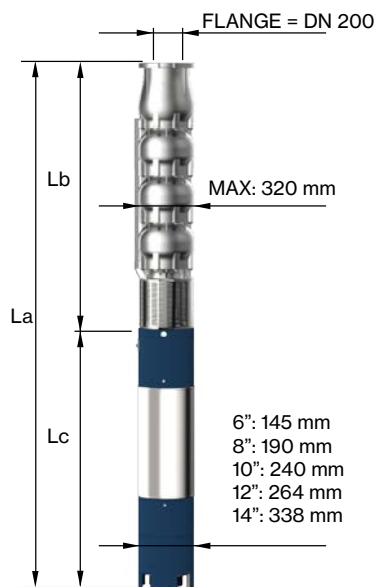

FOR COMMERCIAL TUBE
EXTERNAL : 219,1 mm

"R": Reduced diameter impellers

TYPE	MOTOR BRACKET	ST	DIMENSIONS (mm)			WEIGHT (kg)		
			La	Lb	Lc	La	Lb	Lc
3~								
FX12 360/01R35-050	8" NEMA	1	1970	770	1200	217	79	138
FX12 360/01R20-080		1	2200	770	1430	262	79	183
FX12 360/01-090		1	2230	770	1460	272	79	193
FX12 360/02R35-100	10"	2	2480	1000	1480	304	104	200
FX12 360/02R20-150		2	2920	1000	1920	489	104	385
FX12 360/02-180		2	3020	1000	2020	539	104	435
FX12 360/03R20-200	12"	3	3370	1230	2140	629	129	500
FX12 360/03R10-260		3	3210	1230	1980	779	129	650
FX12 360/03-300		3	3340	1230	2110	829	129	700
FX12 360/04R20-300	14"	4	3570	1460	2110	854	154	700
FX12 360/04R10-340		4	3740	1460	2280	929	154	775
FX12 360/04-400		4	3740	1460	2280	929	154	775
FX12 360/05R20-340	14"	5	3970	1690	2280	954	179	775
FX12 360/05R10-400		5	3970	1690	2280	954	179	775
FX12 360/05-450		5	3850	1690	2160	1089	179	910
FX12 360/06R10-500	14"	6	4240	1920	2320	1214	204	1010
FX12 360/06-550		6	4380	1920	2460	1314	204	1110



TYPE 3~	MOTOR BRACKET	ST	DIMENSIONS (mm)			WEIGHT (kg)		
			La	Lb	Lc	La	Lb	Lc
FX12 400/01R30-050	8" NEMA	1	1970	770	1200	217	79	138
FX12 400/01R20-080		1	2200	770	1430	262	79	183
FX12 400/01R10-080		1	2200	770	1430	262	79	183
FX12 400/01-090		1	2230	770	1460	272	79	193
FX12 400/02R30-100		2	2480	1000	1480	304	104	200
FX12 400/02R20-125		2	2780	1000	1780	355	104	251
FX12 400/02R10-150	10"	2	2920	1000	1920	489	104	385
FX12 400/02-180		2	3020	1000	2020	539	104	435
FX12 400/03R20-200		3	3370	1230	2140	629	129	500
FX12 400/03R10-230		3	3470	1230	2240	669	129	540
FX12 400/03-260	12"	3	3210	1230	1980	779	129	650
FX12 400/04R20-260		4	3440	1460	1980	804	154	650
FX12 400/04R10-300		4	3570	1460	2110	854	154	700
FX12 400/04-340		4	3740	1460	2280	929	154	775
FX12 400/05R10-400		5	3970	1690	2280	954	179	775
FX12 400/05-450	14"	5	3850	1690	2160	1089	179	910
FX12 400/06-500		6	4240	1920	2320	1214	204	1010



FX14 500

50 Hz - 2900 rpm						Q									
TYPE	WITH FME MOTOR				l/min	0	1333	2667	4000	5333	6667	8000	8500	9667	
	P2		Ø	3- 400V	l/sec	0	22,2	44,5	66,7	88,9	111,1	133,3	141,8	161,2	
	HP	kW		A	m³/h	0	80	160	240	320	400	480	510	580	
FX14 500/1D-090	90	67	8"	129	H (m)	72	67	63	59	54	49	42	38	-	
FX14 500/1C-100	100	75		145		77	72	68	64	60	55	55	48	45	39
FX14 500/1B-125	125	93		181		85	80	76	72	68	63	58	55	55	48
FX14 500/1A-150	150	110	10"	217		97	91	86	80	76	71	65	63	58	
FX14 500/1-180	180	130		257		109	99	92	87	83	78	73	71	64	
FX14 500/2D-180	180	130		257		144	133	125	117	109	98	83	76	-	
FX14 500/2C-200	200	150	12"	300		154	143	135	128	119	109	96	90	78	
FX14 500/2B-260	260	190		371		170	160	151	144	136	127	115	110	96	
FX14 500/2A-300	300	220		424		194	182	171	161	151	141	131	126	115	
FX14 500/2-340	340	250		481		217	199	185	174	165	156	146	142	128	

Eff. max %	82,3
Max kW / St. D (230mm) =	64,9
Max kW / St. C (238mm) =	74
Max kW / St. B (251mm) =	90,8
Max kW / St. A (268mm) =	109,1
Max kW / St. - (276mm) =	119,3

NPSH (m)	Q=25%	Q=50%	Q=75%	Q=100%
	5,8	6,4	9,4	15,3



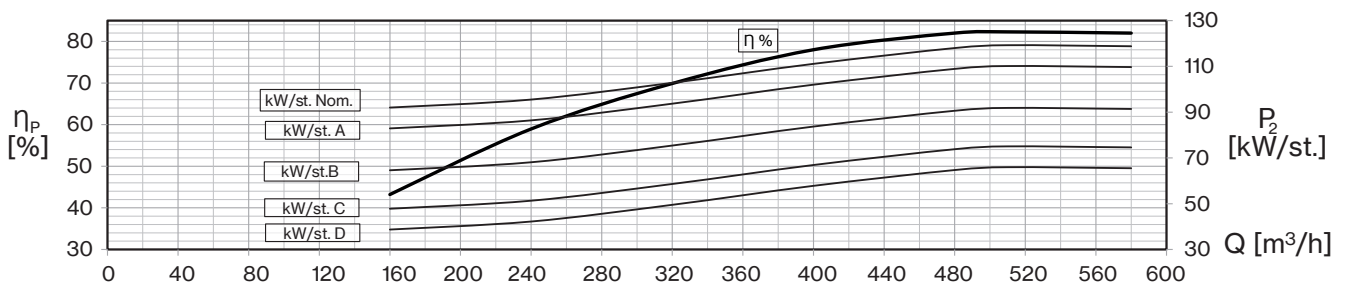
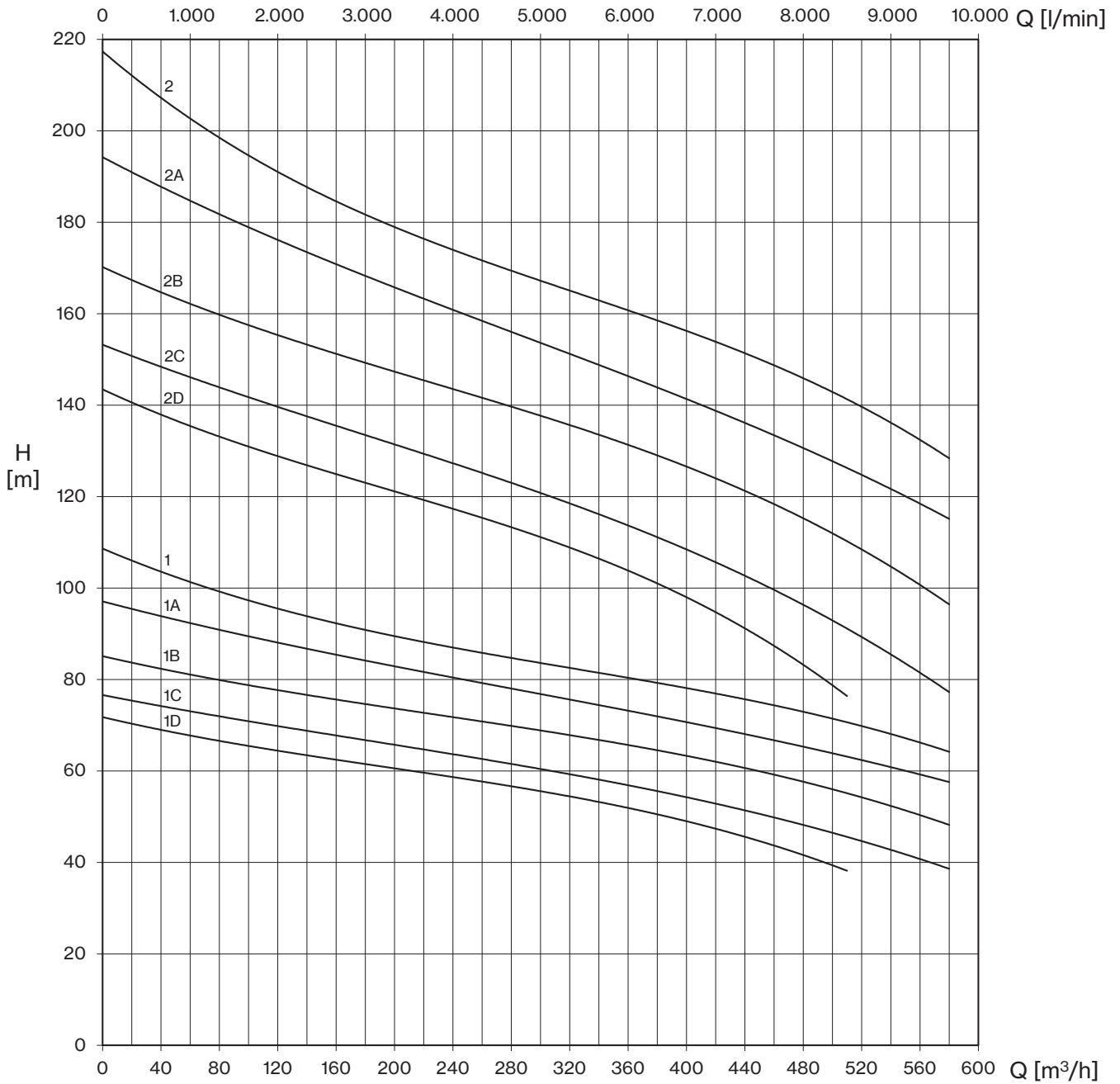

FX14 700

50 Hz - 2900 rpm					Q									
TYPE	WITH FME MOTOR				l/min	0	1333	4000	5333	6667	9000	10000	12500	14333
	P2		Ø	3~ 400V	l/sec	0	22,2	66,7	88,9	111,1	150	166,7	208,3	238,9
	HP	kW		A	m³/h	0	80	240	320	400	540	600	750	860
FX14 700/1C-125	125	93	8"	181	H (m)	74	73	68	64	58	44	37	14	-
FX14 700/1B-150	150	110		217		80	80	75	72	66	54	47	27	-
FX14 700/1A-180	180	130	257	87		84	79	77	74	66	62	46	29	
FX14 700/1-200	200	150	300	101		97	90	87	83	74	69	54	38	
FX14 700/2C-260	260	190	12"	371		147	145	136	127	116	88	73	28	-
FX14 700/2B-300	300	220		424		161	159	150	143	132	107	93	53	-
FX14 700/2A-400	400	300		575		174	168	158	154	148	132	123	91	58
FX14 700/2-400	400	300		575		202	195	181	174	166	148	138	108	77

Eff. max %	78,6
Max kW / St. C (240mm) =	91,8
Max kW / St. B (D. 250mm) =	109,7
Max kW / St. A (259mm) =	129,6
Max kW / St. - (274mm) =	149,6

NPSH (m)	Q=25%	Q=50%	Q=75%	Q=100%
		6	6,4	8,6



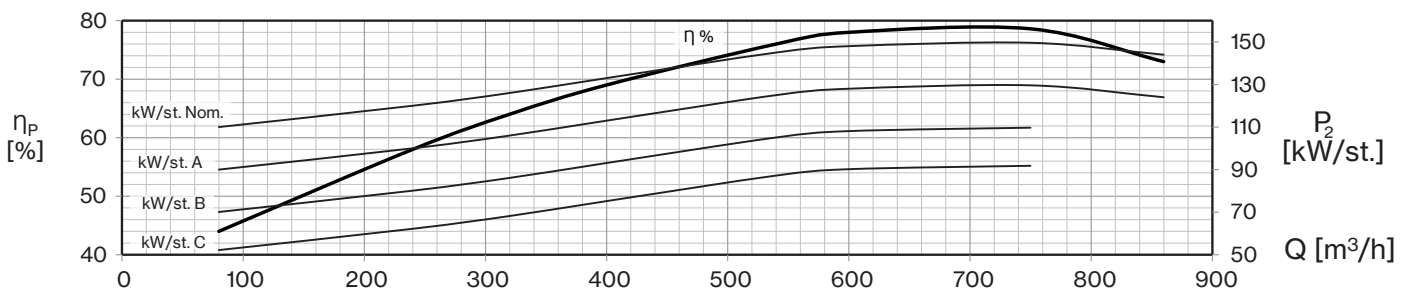
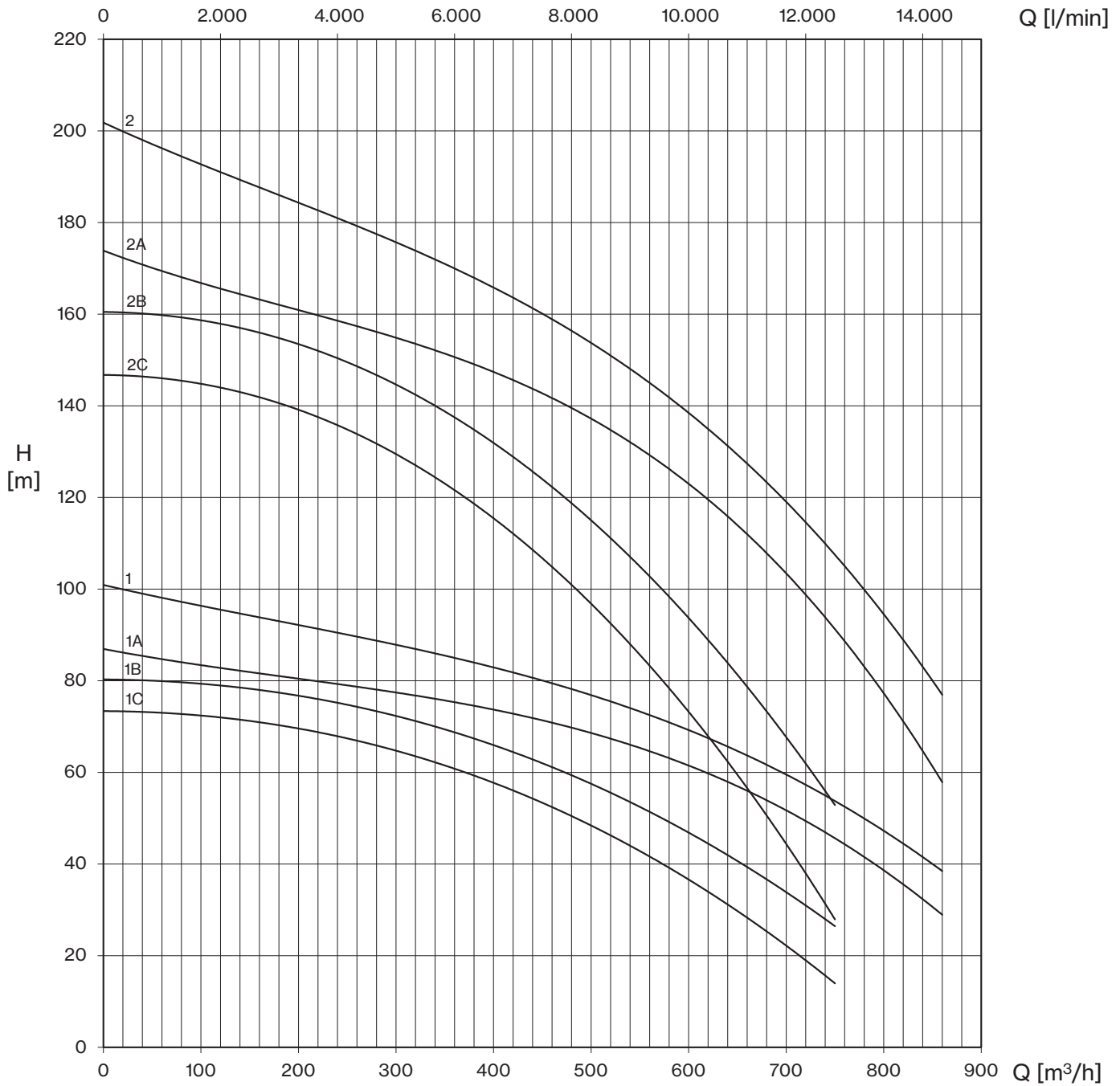

FX14

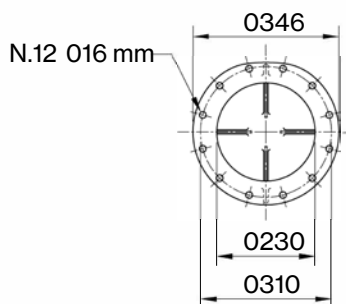
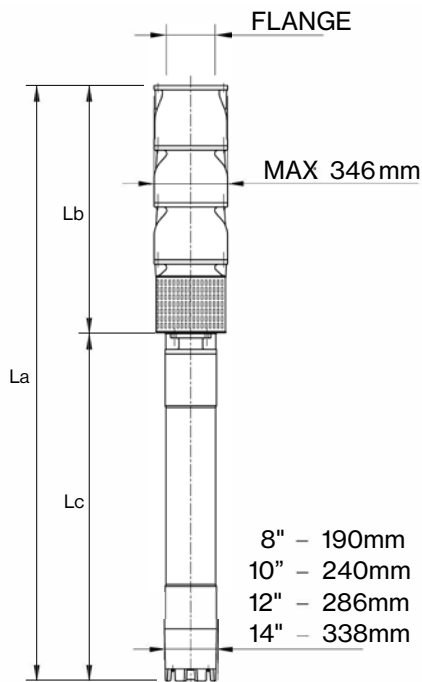

TYPE	MOTOR BRACKET	ST	DIMENSIONS (mm)			WEIGHT (kg)		
			La	Lb	Lc	La	Lb	Lc
3~								
FX14 500/1D-090	8" NEMA	1	2395	935	1460	377	184	193
FX14 500/1C-100		1	2415	935	1480	384	184	200
FX14 500/1B-125		1	2715	935	1780	435	184	251
FX14 500/1A-150	10"	1	2855	935	1920	569	184	385
FX14 500/1-180		1	2955	935	2020	619	184	435
FX14 500/2D-180		2	3195	1175	2020	695	260	435
FX14 500/2C-200	12"	2	3315	1175	2140	760	260	500
FX14 500/2B-260		2	3155	1175	1980	910	260	650
FX14 500/2A-300		2	3285	1175	2110	960	260	700
FX14 500/2-340		2	3455	1175	2280	1035	260	775

TYPE	MOTOR BRACKET	ST	DIMENSIONS (mm)			WEIGHT (kg)		
			La	Lb	Lc	La	Lb	Lc
3~								
FX14 700/1C-125	8" NEMA	1	2715	935	1780	435	184	251
FX14 700/1B-150	10"	1	2855	935	1920	569	184	385
FX14 700/1A-180		1	2955	935	2020	619	184	435
FX14 700/1-200		1	3075	935	2140	684	184	500
FX14 700/2C-260	12"	2	3155	1175	1980	910	260	650
FX14 700/2B-300		2	3285	1175	2110	960	260	700
FX14 700/2A-400		2	3455	1175	2280	1035	260	775
FX14 700/2-400		2	3455	1175	2280	1035	260	775



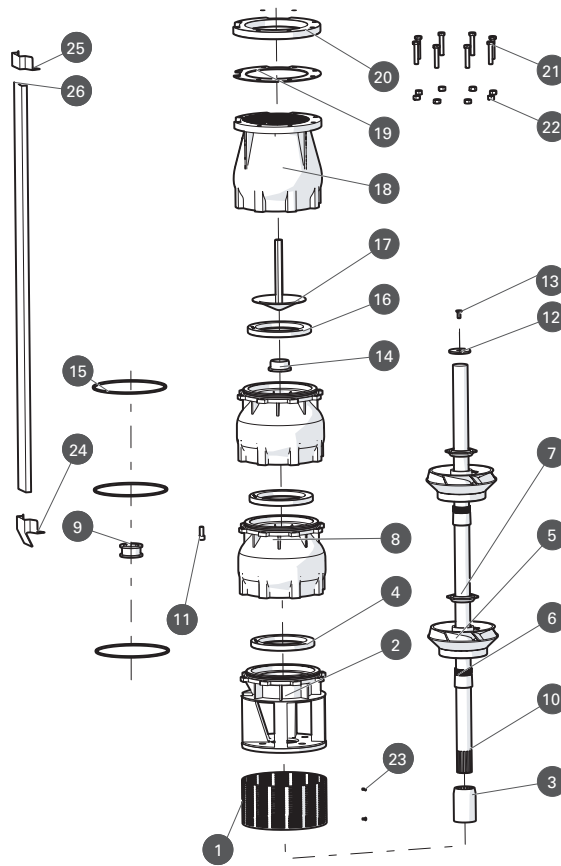

N. CODE	DESCRIPTION	MATERIAL
		FX10-12
1	SUCTION FILTER	STAINLESS STEEL AISI 316
2	MOTOR BRACKET	STAINLESS STEEL AISI 316
3	COUPLING	STAINLESS STEEL AISI 316
4	WEAR RING	NBR
5	IMPELLER	STAINLESS STEEL AISI 316
6	CONE	STAINLESS STEEL AISI 316
7	HEXAGONAL RING	STAINLESS STEEL AISI 316
8	DIFFUSER	STAINLESS STEEL AISI 316
9	BUSHING	NBR
10	PUMP SHAFT	STAINLESS STEEL AISI 316
11	8 DIFFUSER SCREWS	STAINLESS STEEL AISI 316
12	RING	STAINLESS STEEL AISI 316
13	DISC SCREW	STAINLESS STEEL AISI 316
14	COUNTER-PRESSURE THRUST	POM-C
15	O-RING	NBR
16	VALVE GASKET	NBR
17	VALVE CAP	A STAINLESS STEEL ISI 316
18	VALVE BODY	STAINLESS STEEL AISI 316
19	COUNTER-FLANGE GASKET	NBR
20	COUNTER-FLANGE	STAINLESS STEEL AISI 316
21	8 COUNTER-FLANGE SCREWS	STAINLESS STEEL AISI 316
22	8 COUNTER-FLANGE NUTS	STAINLESS STEEL AISI 316
23	2 SUCTION FILTER SCREWS	STAINLESS STEEL AISI 316
24	LOWER CLAMP	STAINLESS STEEL AISI 316
25	UPPER CLAMP	STAINLESS STEEL AISI 316
26	CABLE COVER	STAINLESS STEEL AISI 316

* Recommended quantity of spare parts



FX14

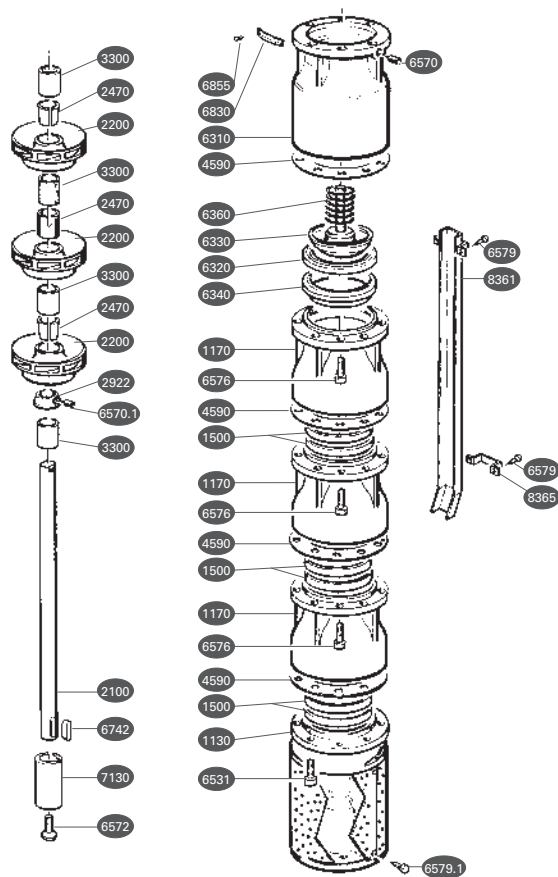

N. CODE	DESCRIPTION	MATERIAL
1130	MOTOR BRACKET	STAINLESS STEEL AISI 316
1170	DIFFUSER	STAINLESS STEEL AISI 316
1500	WEAR RING	PU /
2100	SHAFT	STAINLESS STEEL AISI 316
2200	IMPELLER	STAINLESS STEEL AISI 316
2470	BUSHING	EPDM
2922	SAND GUARD	STAINLESS STEEL AISI 316
3300	BEARING	STAINLESS STEEL AISI 316 / EPDM
4590	GASKET	EPDM
6310	VALVE BODY	STAINLESS STEEL AISI 316
6320	WASHER	EPDM
6330	HOUSING RING	STAINLESS STEEL AISI 316
6340	HOUSING RING	STAINLESS STEEL AISI 316
6360	SPRING	STAINLESS STEEL AISI 316
6531	FILTER	STAINLESS STEEL AISI 316
6570-6579	SCREWS	STAINLESS STEEL AISI 316
6742	KEY	STAINLESS STEEL AISI 316
6830	LABEL	STAINLESS STEEL AISI 316
6855	PLUG	STAINLESS STEEL AISI 316
7130	COUPLING	STAINLESS STEEL AISI 316
8361	CABLE COVER	STAINLESS STEEL AISI 316
8365	CABLE COVER CLIP	STAINLESS STEEL AISI 316

* Recommended quantity of spare parts

